

DATE	12/5/99
DRAWN BY	JLB
CHECKED BY	JLB
REVISIONS:	
1	12/20/99
	FIRE LANE REVISION
2	3/10/00
	REVISIONS
	PER ARCHITECT



**NOTES**

1. THE CONTRACTOR IS SPECIFICALLY CAUTIONED THAT THE LOCATION AND/OR ELEVATION OF EXISTING UTILITIES AS SHOWN ON THESE PLANS IS BASED ON RECORDS AND WHERE POSSIBLE MEASUREMENTS TAKEN IN THE FIELD. THIS INFORMATION IS NOT TO BE RELIED UPON AS BEING EXACT OR COMPLETE. THE CONTRACTOR MUST CALL TENNESSEE ONE CALL AND ANY UTILITY THAT DOES NOT SUBSCRIBE TO ONE CALL AT LEAST 72 HOURS BEFORE ANY EXCAVATION. TO REQUEST EXACT FIELD LOCATION OF THE UTILITIES, IT SHALL BE THE RESPONSIBILITY OF THE CONTRACTOR TO IDENTIFY ALL EXISTING UTILITIES WHICH CONFLICT WITH THE PROPOSED IMPROVEMENTS SHOWN ON THE PLANS.
2. SET SURVEY SHEET FOR LOCATIONS OF UTILITIES, ETC. BENEATH AREAS TO BE DEMOLISHED.
3. UNLESS SPECIFICALLY INDICATED FOR REMOVAL, ALL EXISTING TREES SHALL REMAIN AND SHALL BE PROTECTED DURING CONSTRUCTION AS SPECIFIED IN THE PROJECT MANUAL. FLAG ALL TREES TO BE REMOVED AND VERIFY WITH ARCHITECT FOR APPROVAL PRIOR TO REMOVING ANY TREES.
4. NO MATERIALS SHALL BE STORED OR VEHICLES PARKED WITHIN THE DRIP LINE OF ANY TREE TO REMAIN.

**LEGEND**

- NEW 4" CONCRETE
- EXPANSION JOINT
- NEW CURB
- NEW BUILDING
- EXIST EDGE OF PAVEMENT
- EXIST BUILDING
- EXIST TREES
- ALT. 1 LIMITS

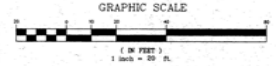
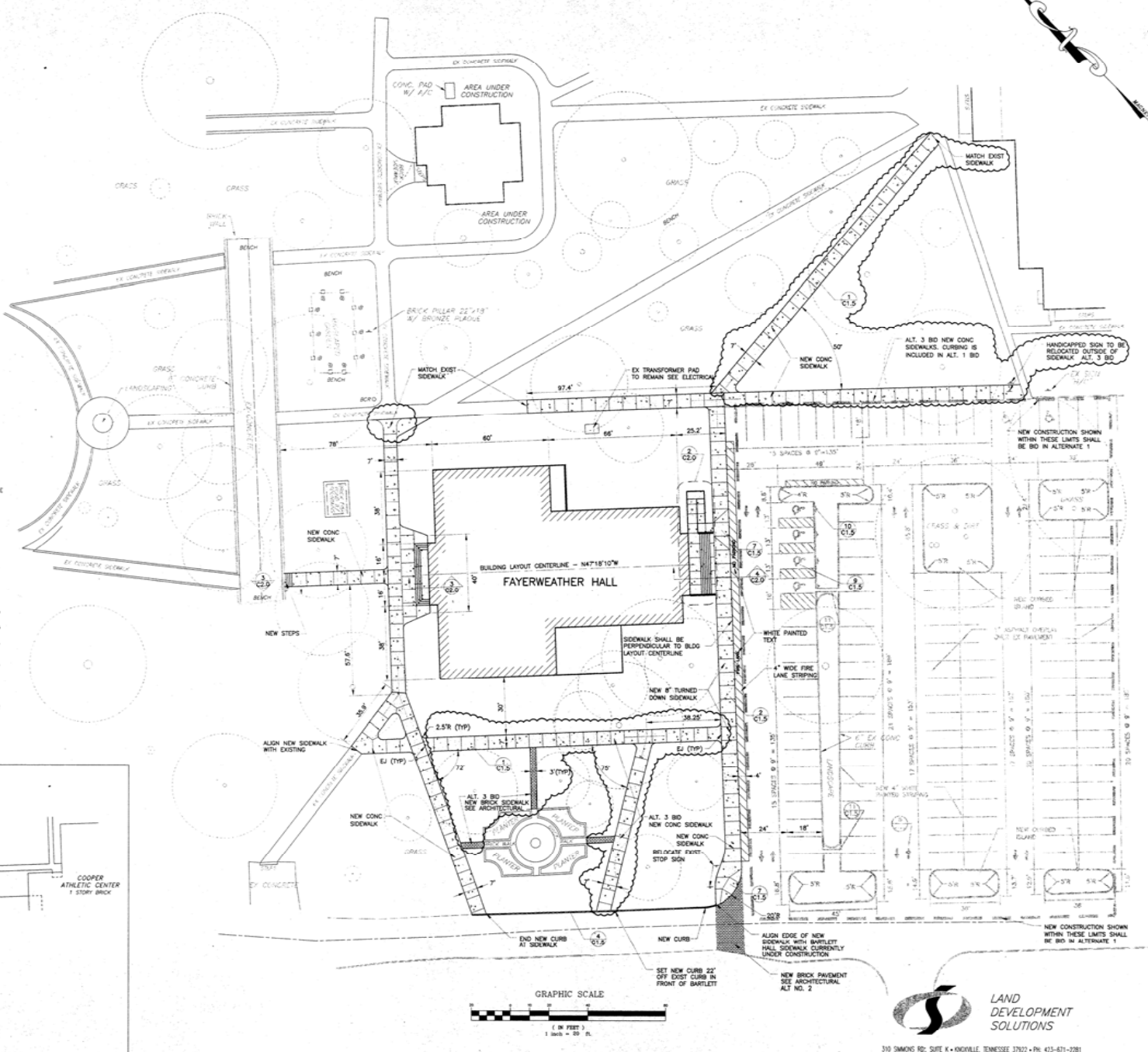
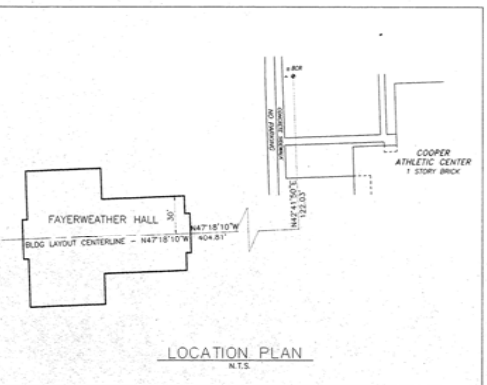

**LAND DEVELOPMENT SOLUTIONS**  
 310 SIMONS RD, SUITE K • KNOXVILLE, TENNESSEE 37922 • PH 423-671-2281