



LAND DEVELOPMENT SOLUTIONS

310 SIMMONS RD., SUITE K-KNOXVILLE, TENNESSEE 37922
PH. 865-671-2281

CORRYTON BAPTIST CHURCH
7615 FOSTER ROAD
CORRYTON, TN 37721

Site Layout Plan

AS INSTRUMENTS OF SERVICE, THESE DRAWINGS AND THE DESIGN REPRESENTED BY THEM ARE THE PROPERTY OF DAMON A. FALCONNIER AND AS SUCH ARE PROTECTED BY STATE AND FEDERAL COPYRIGHT LAWS. REPRODUCTION OR USE OF THESE DRAWINGS OTHER THAN FOR THE PROJECT INTENDED WITHOUT WRITTEN CONSENT FROM DAMON A. FALCONNIER IS PROHIBITED. UNAUTHORIZED USE WILL BE SUBJECT TO LEGAL ACTION.

DRAWN BY:	CDB
CHECKED BY:	EJB
ISSUED:	11/16/10
REVISION(S):	
FILE:	

C101

LOCATION MAP

GENERAL NOTES

- The contractor is specifically cautioned that the location and/or elevation of existing utilities as shown on these plans is based on records and where possible measurements taken in the field. This information is not to be relied upon as being exact or complete. The contractor must call Tennessee One Call and any utility that does not subscribe to One Call at least 72 hours before any excavation, to request exact field location of the utilities. It shall be the responsibility of the contractor to relocate all existing utilities which conflict with the proposed improvements shown on the plans.
- Owner: Corryton Baptist Church
7615 Foster Road
Corryton, Tennessee 37721
- Survey by: Land Development Solutions
310 Simmons Road, Suite K
Knoxville, TN 37922
Ph. 865-671-2281
- Property is located in Knox County and is zoned RB & A.
- Lot acreage = Approx 50.6 acres.

LAYOUT NOTES

- All dimensions to curb line reference face of curb - see detail.
- See Utility Plan for new and existing utility line locations. See Grading and Drainage Plan for new and existing storm drain locations.

LEGEND

- BENCHMARK
- PROPERTY LINE
- EXISTING CURB LINE
- NEW CURB LINE
- NEW BUILDING EDGE
- EXISTING BUILDING EDGE

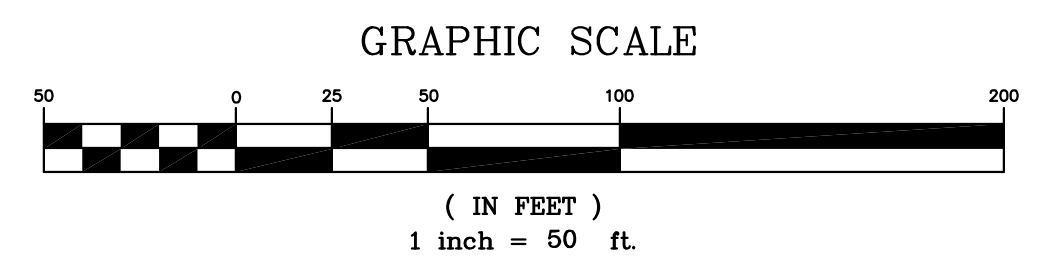
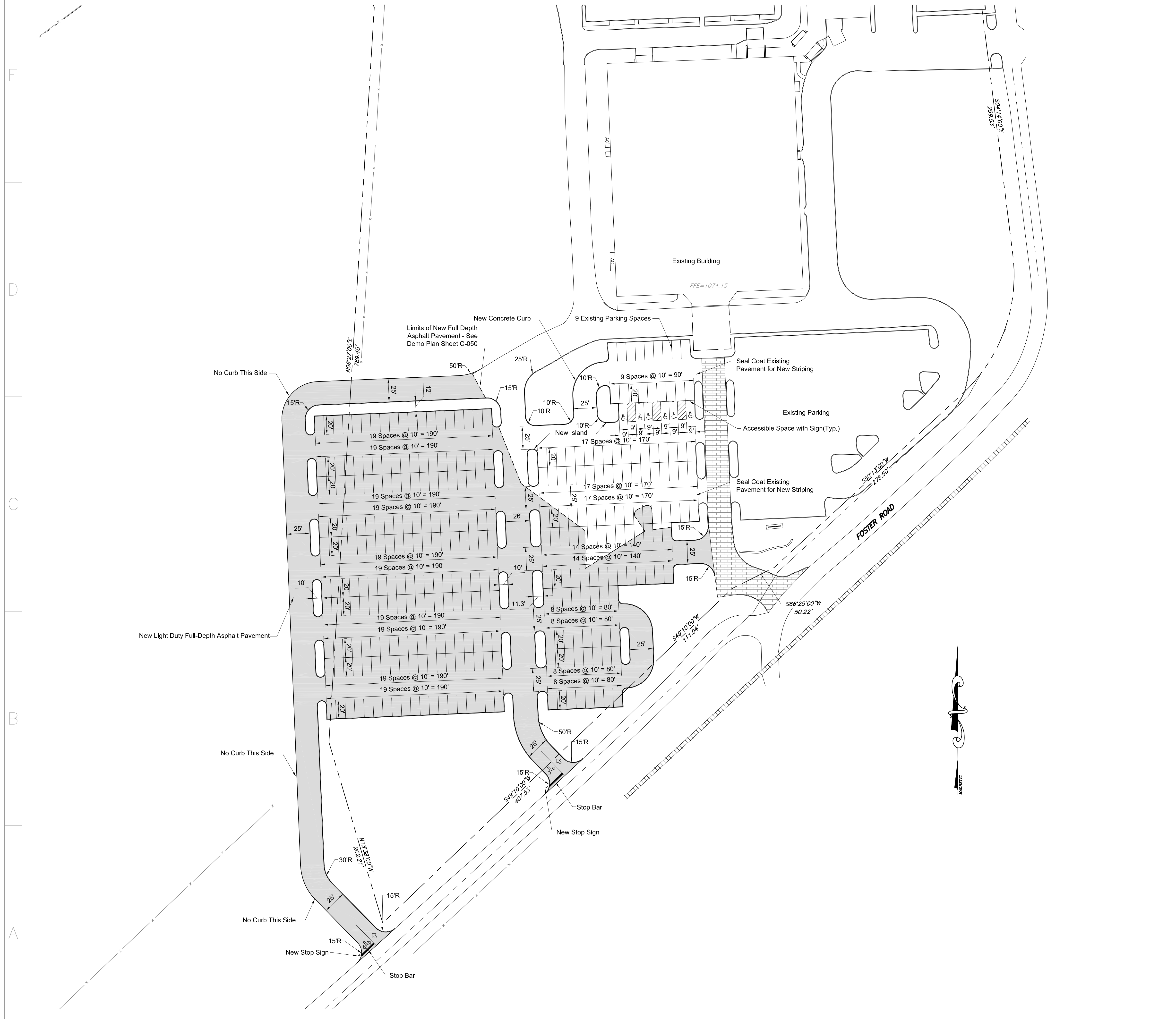

X:\Chad\Corryton Baptist Church\dwg\C101.dwg Nov 17, 2010 - 12:03pm cbrown - LDS Copyright 2010