

REVISION NO. 7 NOTES

- NEW 8" WIDE WHITE PAINTED STRIPE TRANSITION FROM 28" WIDE LANE TO 26" WIDE LANE WITH 100' RADIUS. CENTER POINT= N 575372.78 E 2518295.33
- NEW 8" WIDE WHITE PAINTED STRIPE TRANSITION FROM 28" WIDE LANE TO 26" WIDE LANE WITH 100' RADIUS. CENTER POINT= N 575299.32 E 2518495.41
- PARKING SPACE SUMMARY:
21 E.R. SPACES (5 DISABLED) TO BE STRIPED WITH RED PAINT. 1 E.R. SPACE ELIMINATED AND LANDSCAPE ISLAND SIZE INCREASED TO ACCOMMODATE WATER VAULT.
267 SPACES STRIPED AS EMPLOYEE SPACES - LIGHT GREEN STRIPING
16 OF THE EMPLOYEE SPACES SHALL BE DESIGNATED AS PHYSICIAN PARKING WITH PAINTED TEXT "PHYSICIAN PARKING ONLY" WITH 8" HIGH WHITE LETTERS

REVISION NO. 7 LEGEND

- EMPLOYEE PARKING - LIGHT GREEN STRIPING
- P SPACE TO MARKED "PHYSICIAN ONLY PARKING"

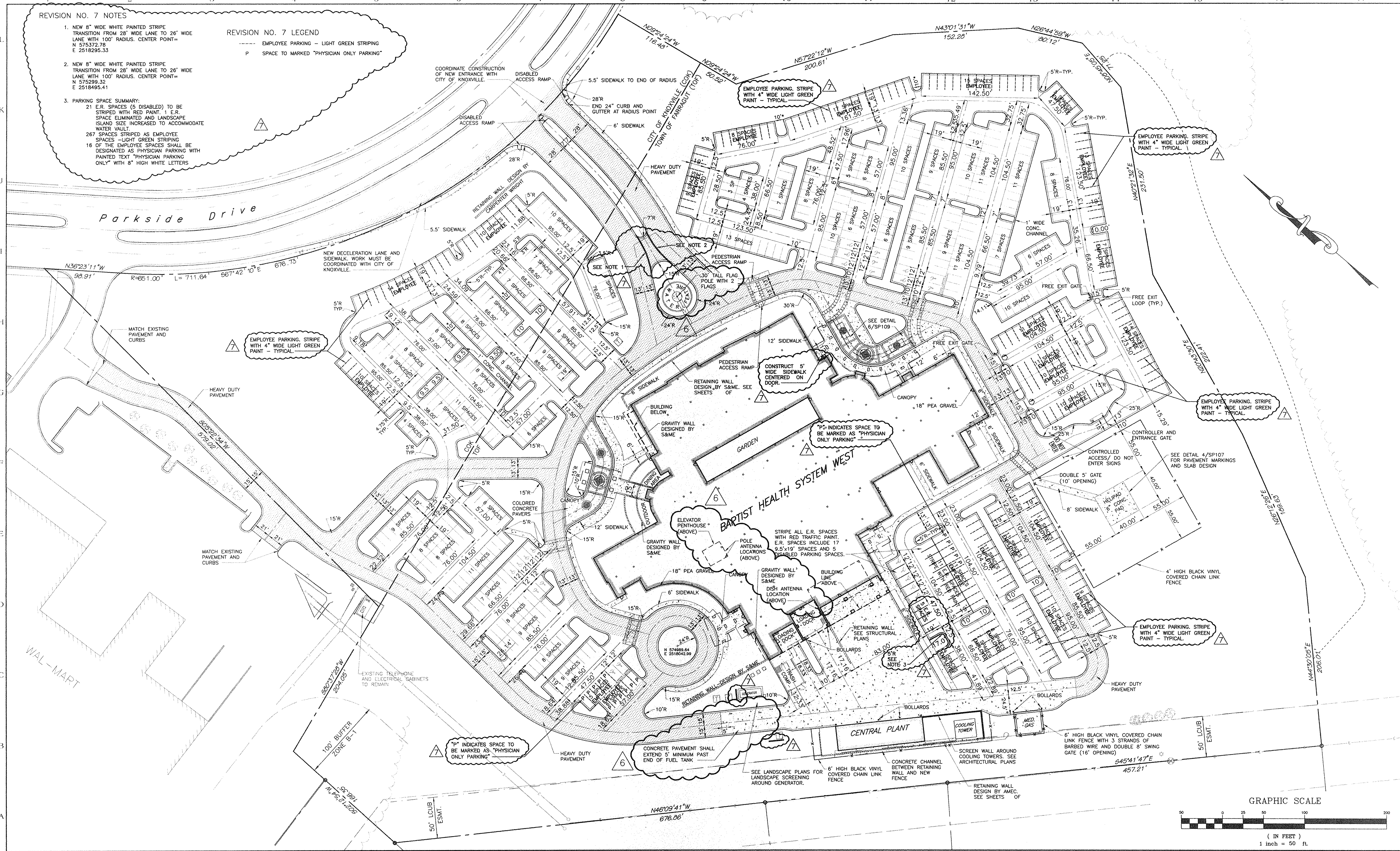

C:\vs projects\Baptist Hospital\dwg\Baptist West Master.dwg Apr 22, 2003 - 11:10am Breck

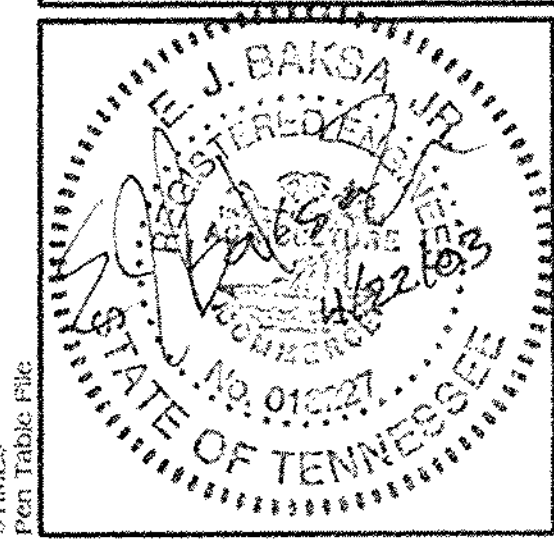

LAND DEVELOPMENT SOLUTIONS
310 SIMMONS RD., SUITE K • KNOXVILLE, TENNESSEE 37922 • PH: 865-671-2281

Number	Revisions	Date
7	REVISED PARKING TO SHOW EMPLOYEE SPACES INCREASED SIZE OF LANDSCAPE ISLAND @ E.R. ALIBI STRIPING @ BOLLIVARD OPENING ALIBI WALLS @ TRANSFORMERS & GENERATOR	4/22/03
6	ADDED FLAG POLE & ANTENNA LOCATIONS	1/17/03
5	TOWN OF FARRAGUT RESUBMITTAL	5/17/02
4	FINAL CD PACKAGE	4/01/02
3	TOWN OF FARRAGUT COMMENTS	1/22/01
2	DESIGN DEVELOPMENT SUBMISSION	11/22/01
1	GENERAL REVISIONS	11/07/01

BARBER & McMURRY INCORPORATED
ARCHITECTS • PLANNERS • CONSULTANTS | ESTABLISHED 1915
623 LINDSAY PLACE KNOXVILLE TENNESSEE 37919 865-546-7441 FAX 865-546-0242

BAPTIST HEALTH SYSTEM WEST
10820 PARKSIDE DRIVE
KNOXVILLE, TENNESSEE

SP101
SITE LAYOUT PLAN
SHEET OF